

Check your
cold chain
automatically
and in total safety

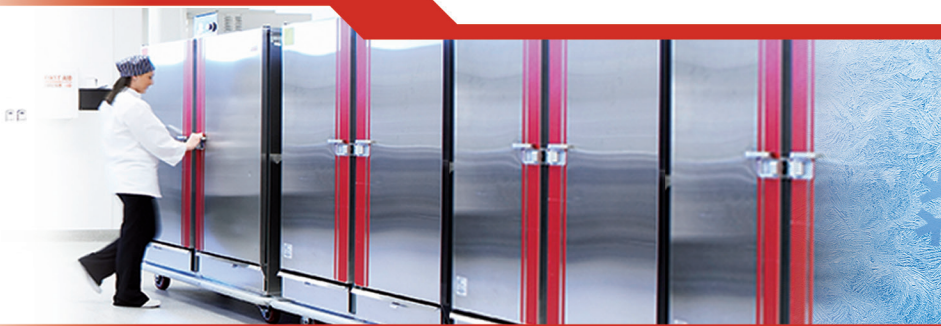

> THE COLD CHAIN UNDER CLOSE SURVEILLANCE

In the cold chain, particular care is taken to monitor the temperatures in order to guarantee healthy, safe conditions. All the links in the chain must be monitored with the same attention: cold rooms, larders, freezers, preparation areas, etc.

Crucial features for a reliable monitoring system:

- Continuous checking of the temperatures in cold areas
- Automatic recording of values 24 hours a day
- Secure data processing
- Surveillance of utilities
- Alarms and alert systems
- Optimization of energy costs

> THE PYROCONTROLE SOLUTION

The CPS Touch[®] Human-Machine Interfaces for touch screens allow users to:

Display all the parameters on the screen

- Centralization of the information
- Tailored representation of the installation
- Clear display of the process values per zone (temperature, pressure, etc.)
- Indication of the status of the machines and utilities

Check and monitor

- Continuous temperature recording
- Individual supervision of each area and monitoring of technical faults on the machines
- Visual, audio or remote indication
- Remote monitoring via the Ethernet link

Process and manage the data with total security

- Time/date-stamped recordings and events log
- Protection of the data in compliance with FDA 21 CFR part 11
- User management with security levels
- Simplified data processing
- Backup and printing of reports

AGRI-FOOD

Testing

Safety

Reliability

Simplicity



> PYROCONTROLE'S GLOBAL SUPERVISION OFFERING

Installation of a CPS Touch® Human-Machine Interface linked to Pt100 temperature sensors installed in the cold rooms and connected to the PDM I/O modules.

Diagram of a refrigeration installation

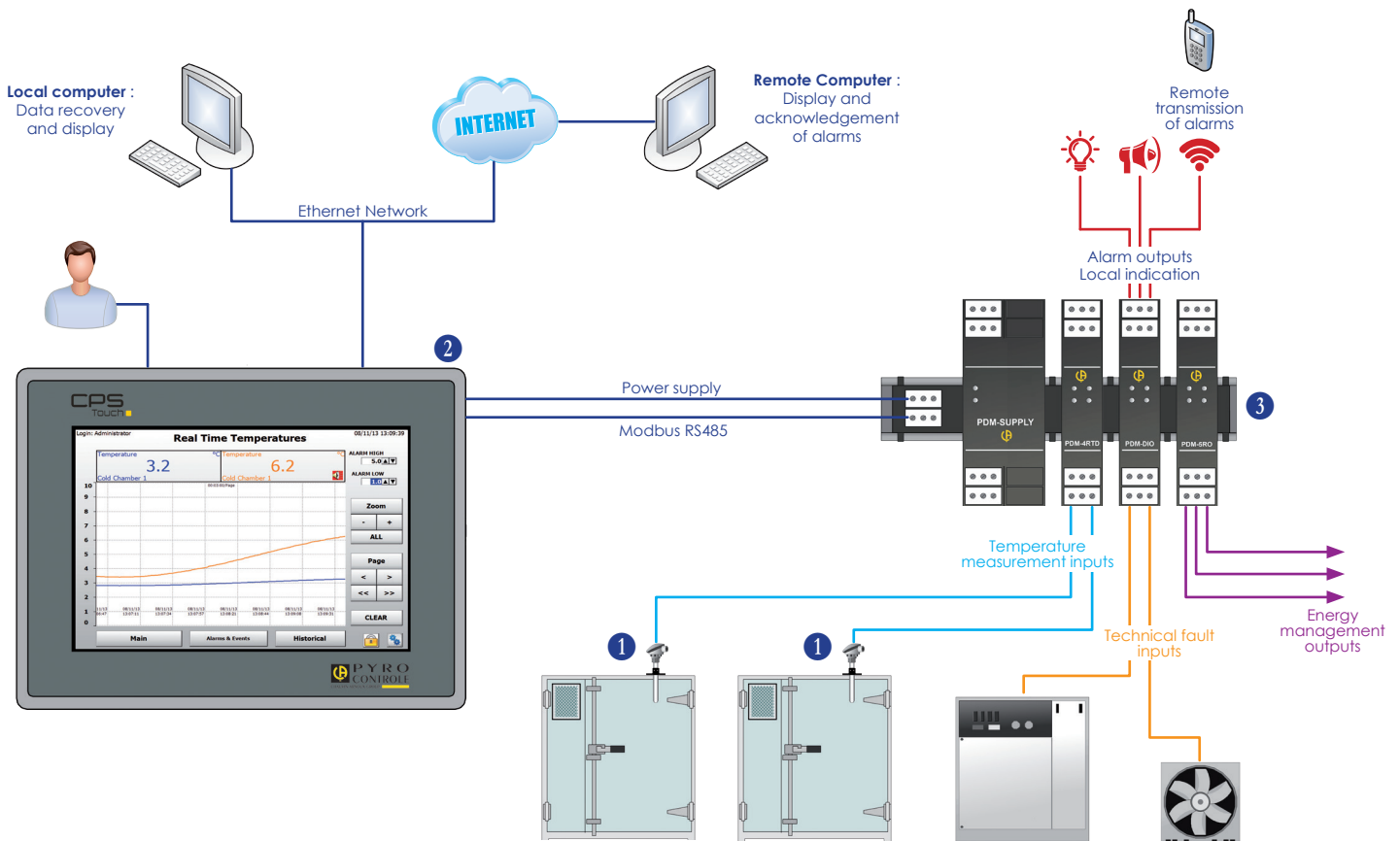

Components of the installation

- 1 Temperature sensors: **Pyrocontrole Pt100 sensors**
- 2 **CPS Touch® Human-Machine Interface** : handles display, monitoring and recording of the data
Available in various sizes: 4.3", 7", 10" or 15"
- 3 **PDM input/output modules**: interface between the installation and CPS Touch®
 - PDM-SUPPLY: auxiliary power supply
 - PDM-4RTD: temperature measurements
 - PDM-DIO: monitoring of technical faults and indication of the alarms on relays
 - PDM-5RO: energy management with standby modes

Wireless installation: to limit the wiring costs, PDM module "islands" can be set up as close as possible to the measurement points. Communication with CPS Touch® then uses the Modbus RTU protocol via an RS485 link or, as an option, a wireless Radiofrequency link.

> RELATED SERVICES

- Engineering assistance
- Development of specific applications according to your specifications

A team of experts is available to support you: +33 4.72.14.15.52 / automation@pyro-controle.tm.fr

PYROCONTROLE

6 bis, av du Docteur Schweitzer
69881 MEYZIEU Cedex - France
Tel : +33 4 72 14 15 40
Fax : +33 4 72 14 15 41
info@pyro-controle.tm.fr
www.pyro-controle.com

